



**4693-4698**

**USER MANUAL**



## Summary

1. INTRODUCTION .....	4
2. ARMING AND DISARMING THE SYSTEM .....	4
3. ACTIVE FUNCTIONS (functions description) .....	5
4. FUNCTIONS PROGRAMMABLE BY A COBRA INSTALLER (functions description) .....	7
5. EMERGENCY OVERRIDE .....	10
6. REMOTE CONTROL BATTERY REPLACEMENT .....	11
7. DRIVER CARD BATTERY REPLACEMENT .....	12
8. TROUBLESHOOTING GUIDE .....	13
9. WARRANTY TERMS .....	14
10. UK MARKET .....	14
11. CONFORMITY DECLARATIONS .....	15

*Dear Customer,*

*The product you've chosen is in line with the quality and functional standards required by the main Car Manufacturers and it complies with the safety and security European directives. The technology used for the remote controls and the Driver cards guarantees an high level of security toward attempts to reproduce the digital code. We would like to remind you that the security degree of this system can be increased by adding the following modules:*

### **LEVEL MONITOR**

This sensor detect the vehicle being jacked up to for towing it away or for stealing the wheels.

### **HYPERFREQUENCY VOLUMETRIC SENSOR**

It is a volumetric sensor for interior protection required for convertible vehicles as it is not sensitive to air movements.

### **CRANK INHIBITION**

To add another crank inhibition to the system.

### **WINDOW CLOSING**

Fitting this module the electric windows will raise automatically when the system is armed.

### **TRACKING DEVICE**

Allow to track your vehicle and to send alerts to a Secure Operating Center.

*In this manuals we've listed all the standard system functionalities and those you can ask to active to an authorized Cobra fitting centre. Please read carefully this manual to get the full benefit from the product.*

## 1. - INTRODUCTION.

This system can be armed / disarmed with the remote control or with the Driver Card (optional).

## 2. - ARMING AND DISARMING OF THE SYSTEM.

To arm the system press the “A” pushbutton of the remote control.

The arming status is confirmed by:

- vehicle doors locking;
- Audible signals (if activated);
- Flashes of the direction lights;
- LED of the emergency panel illuminated.

The protection features of the system become active after a 25 s arming period has elapsed (when the LED of the emergency panel starts blinking).

**Button A** > to arm the alarm and to lock doors.

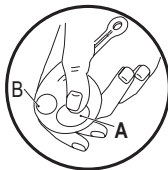

To disarm the system press the “B” pushbutton of the remote control.

The disarming status is confirmed by:

- Vehicle doors unlocking;
- Audible signals (if activated);
- Flashes of the direction lights;
- LED of the emergency panel OFF.

**Button B** > to disarm the alarm and to unlock doors.

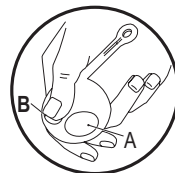

**Note:** if also the Driver Card (optional) is provided it will be also possible to arm and disarm the system by pressing its pushbutton.

The system is delivered with a set of standard functionalities (active functions). The installer is able to activate some more functionalities (programmable functions) with an impact on the security and comfort the system will offer. The following are the lists of the two groups.

### 3. - ACTIVE FUNCTIONS.

#### 3.1 - Interior protection with ultrasonic volumetric sensor.

The system protects the vehicle interior with a volumetric ultrasonic sensor. Any attempt to get into the vehicle will be detected and the alarm will trigger.

#### 3.2 - Perimetric protection with door open warning diagnostic.

The alarm will trigger by opening any door, boot and bonnet. Should you have left any door opened while arming, the system will signal it by 3 flashes of the direction lights and 3 audible signals (5 audible signals if the arming/disarming audible signals function has been activated).

#### 3.3 - Cable cutting protection (only for systems with back-up battery siren).

The alarm will trigger if the system is not power supplied (cutting of cables - battery disconnection) signaling the sabotage.

#### 3.4 - Engine starting inhibition.

As soon as the system is armed the engine starting is not be possible anymore.

#### 3.5 - Arming the system with the volumetric ultrasonic protection disabled.

This function allows to arm the system leaving temporarily disconnected the interior volumetric protection. The protection must be disabled any time you leave somebody or an animal in the vehicle. Also if you want to leave any window opened please disable the protection to avoid false alarms. All other protections remain active.

To disable the volumetric protection proceed as follow:

Arm the system pressing the “A” pushbutton of the remote control, pressing another time the “A” pushbutton the volumetric protection (Ultrasonic sensors) is deactivated, the deactivation is confirmed by one flashing of the direction indicators and one beep.

Pressing another time the “A” pushbutton the volumetric protection is re-activated and the external sensors are deactivated, the deactivation is confirmed by two flashing of the direction indicators and two beeps.

Pressing another time the “A” pushbutton, the volumetric protection and the external sensors are deactivated, the deactivation is confirmed by three flashing of the direction indicators and three beeps, or

switch the engine off being sure that the ignition switch has been turned to the OFF position. Within 5 s press the emergency panel pushbutton and keep it pressed until it will flash once to confirm that the volumetric protection only has been disabled. By keeping the pushbutton pressed the system will confirm with two flashes that the additional sensor input only has been disabled, with three flashes for both of them disabled. The selected protection will remain disabled until the system will be disarmed. It will be automatically restored at the next arming.

### 3.6 - Emergency panel LED.

The LED main scope is to show the system arming and disarming conditions. When the system is armed the LED gets ON and remains illuminated until the 25 s arming period has elapsed. After that it starts blinking. It goes OFF as soon as the system is disarmed.

### 3.7 - Alarms memory.

If the system has gone off (alarm ON) during the arming time it will warn you with 3 flashes of the direction lights and 3 audible signals (5 audible signals if the arming/disarming audible signals function has been activated). It also stores in its memory the reason of the occurred alarm and shows it on the emergency panel LED. Count the number of flashes and check the corresponding alarm reason on the table. By turning the key ON the memory will be deleted.

LED NUMBER OF FLASHES	ALARM ROOT CAUSE
1 flash	Door opening detection.
2 flashes	Ultrasonic volumetric detection.
3 flashes	Bonnet opening detection.
4 flashes	Ignition key ON detection.
5 flashes	Boot opening detection.
6 flashes	Door opening detection.
7 ÷ 14 flashes	“Technical alarm” detection. Contact your installer.

### 3.8 - Emergency disarming.

If the remote control get lost or if it doesn't work, open the door with the mechanical key and disarm the system following the emergency procedure described in step 5.

### 3.9 - Direction lights alarm flashes.

When the system goes off (alarm ON) the siren sounds and the direction lights flash for 28 s.

## 4. - PROGRAMMABLE FUNCTIONS.

### 4.1 - Activation and volume adjustment of the audible arming and disarming signaling.

This function allows to activate a short audible signal to confirm the system's arming and disarming.

### 4.2 - Passive arming.

The system will automatically arm after 30 s the ignition key has been switched off and the driver side door has been opened and closed, so 30 s after the driver has left the vehicle.

### 4.3 - Auto re-arming.

The system will automatically re-arm if, after 115 s, it has been disarmed and no one door has been opened (nobody gets on the vehicle).

### 4.4 - Auto re-arming with doors locking.

As for auto re-arming, but doors will lock.

### 4.5 - Passive engine starting inhibition.

The starting inhibition becomes active after 115 s the vehicle has been switched OFF. The starting inhibition is immediately deactivated if the Driver Card (optional) is detected or when a correct emergency PIN Code has been digit on the emergency panel. This functionality is totally independent from the other ones.

### 4.6 - Confort window closing with remote control.

This is a native function of the vehicle, so at first check if it is available. By keeping pressed the Cobra remote control pushbutton "A" you can close the windows from a distance. If not you can ask your installer to fit an additional window closing module.

**Warning:** for safety reasons we recommend to close the windows remaining close to the vehicle.

#### 4.7 - Anti hi-jacking.

This function helps to prevent the vehicle hi-jack while driving, taking care also to the safety of the driver. If the driver isn't recognized, the system will consider him as an unauthorized person to drive the vehicle; it will generate an alert sequence and it will not allow the engine starting after it has been switched off.

During the normal usage of the vehicle the driver is recognized by the system in two ways:

- **manual (without Driver Card\*)**: by entering the first two Pin Code digits on the emergency panel.

The driver must be recognized by the system every time the ignition key is switched on or when, with the ignition key on, the driver opens and closes the driver side door to get off. If the recognition doesn't happen within 60 s the LED of the system starts to flash quickly, reporting the failed recognition for further 30 s. When this time is expired, the system generates an alert sequence also if the engine is running. The engine cranking inhibition becomes active with the ignition key off, making impossible the engine running. To exit the anti hi-jack function, enter the four digits of the Pin Code.

- **automatic (with Driver Card\*)**: the driver must be recognized by the system when it detects the Driver Card. If the recognition doesn't happen within 60 s the LED of the system starts to flash quickly, reporting the failed recognition for further 30 s. When this time is expired, the system generates an alert sequence also if the engine is

running. The engine cranking inhibition becomes active with the ignition key off, making impossible the engine running. To exit the anti hi-jack function, the system must recognize the Driver Card. If the Driver Card is switched off, press the push-button of the Driver Card to be recognized.

**Warning:** to temporarily deactivate the anti hi-jack function (Driver Card broken or with flat battery), type the four digits of the Pin Code. The function will become active again by opening and closing the driver's door when the ignition key is on or by turning the ignition key ON and OFF.

**Note:** the function is as standard disabled in compliance with the European regulation. Its activation voids the CE homologation. It can be used only in the extra-European countries, if the functionality is not in conflict with the local rules.

---

\* optional



#### 4.8 - Garage mode.

This function allows to temporarily disable all protection automatic functionalities of the system. It can be used, as an example, when you need to leave the vehicle at a workshop for maintenance to avoid the automatic activation of any functionality. When the garage function is active the driver is allowed to turn the ignition key on for 10 times (engine running). After 10 times the system restore all automatic functionalities.

##### Activation

- Open driver side door.
- Turn the ignition key ON.
- Enter the complete emergency PIN Code (4 digits) on the emergency panel pushbutton.
- A flash of the direction lights confirms the activation.

##### Deactivation

- Lock then unlock the vehicle with the original remote control.
- A flash of the direction lights and an audible signal confirm the deactivation.

#### 4.9 - Panic alarm.

If the function is activated, pressing the “A” push-button of the remote control, with the system armed and after the inhibition time of 28 s has elapsed, it allows to generate a 10 s panic alarm. By activating this function it will not be possible to activate the function described in step 4.10.

#### 4.10 - Car finder.

If the function is activated, pressing the “A” push-button of the remote control, with the system armed and after the inhibition time of 28 s has elapsed, it allows to generate a 10 s cycle with the direction lights flashing and buzzer sounding. By activating this function it will not be possible to activate the function described in step 4.9.

#### 4.11 - Personalization Pin Code.

The Personal Identification Code is a four digits code which is already stored in the system. The sticker with the PIN code must be applied by the installer on the PIN code card you should have got from your installer.

Keep the PIN code card always with you. The code is required to emergency override the system the remote control doesn't work or if you've lost it. The PIN code is also used for other scopes (driver recognition code for the anti hi-jack functionality and as activation code for the garage mode). Upon your request and submitting the card to your installer, he will personalize you the PIN code.

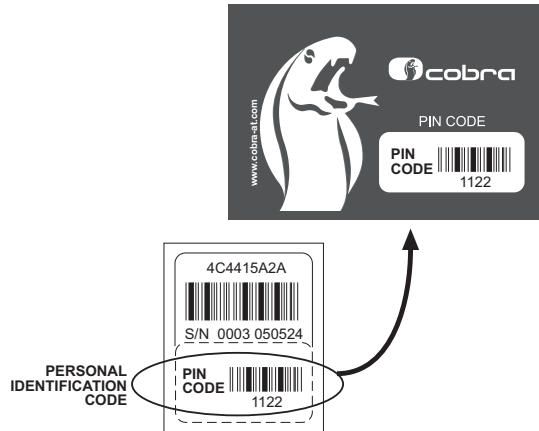

We advise you to stick the **PIN CODE**, which may be found on the rear of the control unit, adhesive label on to the **PIN CODE CARD**.

## 5. - EMERGENCY OVERRIDE WITH PIN CODE.

If the vehicle original remote control get lost or if it doesn't work, open the door with the mechanical key and disarm the system proceeding as follow:

press the emergency panel pushbutton for a number of times corresponding to the first digit of the PIN Code. Each pushbutton pressure is confirmed by a quick flash of the LED. Make a longer pause to let the system understand that you've finished to enter the first digit, a longer flashing of the LED will confirm it. Do the same for the remaining digits, as soon as all four digits will be entered the system will disarm.

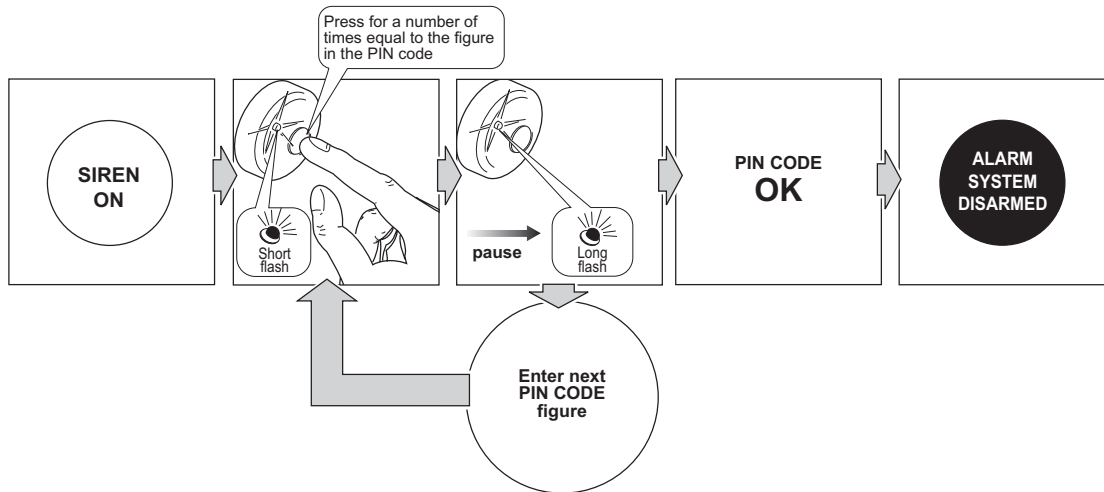

## 6. - REMOTE CONTROL BATTERY REPLACEMENT.

The remote control battery is a CR2032-3V lithium battery.

Its replacement is necessary as soon as, by pressing one of the two pushbuttons, the LED flashes irregularly or just for a short time.

To replace the battery perform the following steps:

- open the remote control shell, being careful to lever it up in the point indicated in the drawing.
- Remove the battery as shown (dispose the empty battery in the appropriate container disposal).
- Wait approximately 10 seconds, then insert the new battery, taking care to make sure your fingers touch it only on the sides. Make sure the polarity is correct, as shown in the drawing.
- close the shell and press the remote control pushbutton “A” to check if the system is properly working.

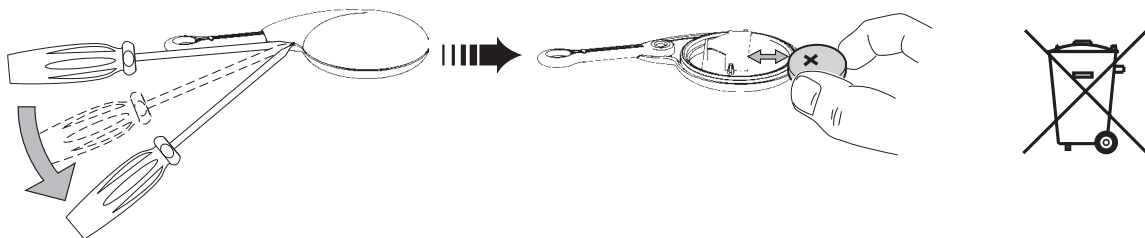

## 7. - DRIVER CARD (optional) BATTERY REPLACEMENT.

The Driver Card battery is a CR2032-3V lithium battery.

When the Driver Card battery is low the emergency panel LED flashes for 10 times. If the system doesn't disarm when the Driver Card is inside the vehicle try to disarm it by pressing the Driver Card pushbutton, otherwise replace the battery.

- To change the battery, open the Driver Card shell, being careful to lever it up at the point the area indicated in the drawing.
- Remove the battery by extracting it in the manner shown.
- Wait approximately 10 s.
- Insert the new battery, taking care to make sure your fingers touch it only on the sides. Make sure its polarity is correct, as indicated in the diagram.
- Close the shell and press the Driver Card button checking that the system responds correctly. Perform the test near the vehicle.
- Dispose of the empty battery in an appropriate disposal - bin.

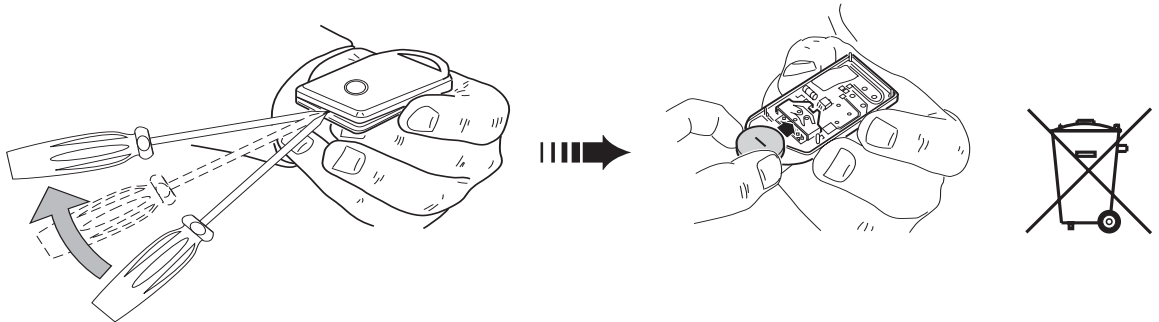

## 8. - TROUBLESHOOTING GUIDE.

THE REMOTE CONTROL DOESN'T ARM/DISARM THE SYSTEM.	
Root cause	Countermeasure
The battery is empty.	a. If the system is armed, perform the emergency override procedure (see step 5).
	b. Replace the battery of the remote control following step 6.
	<b>c. If you cannot solve the problem contact your installer.</b>
THE SYSTEM HAS GENERATED A FALSE ALARM - CHECK ON THE EMERGENCY PANEL LED (ALARM MEMORY FUNCTION) WHICH IS THE ALARM ROOT CAUSE.	
Root cause	Countermeasure
Alarm generated by the volumetric US sensor.	a. Check if the windows and the roof have been closed.
	b. Check if inside the vehicle there is any moving objects or any object that can move because of slow air movements.
	<b>c. If you cannot solve the problem contact your installer.</b>
Alarm generated by door/boot/bonnet opening.	a. Check if all doors/boot and bonnet have been closed.
	<b>b. If you cannot solve the problem contact your installer.</b>

## 9. - WARRANTY CONDITIONS.

This product is guaranteed for 24 months from the date of purchase, validated by receipt or invoice. The warranty will be null and void if the product shows signs of tampering, incorrect installation, damage caused by falling or transport, negligence and anything else not imputable to manufacturing defects.

In the event of improper installation of the system, the manufacturer shall not be liable to compensate for damages:

- of any kind and direct or indirect;
- to things or to persons.

To benefit from warranty coverage, contact your authorized dealer with adequate documentation showing the date of purchase.

## 10. - FOR MARKET ONLY

Thatcham recommends to its insurer members that the installations of certified products within the aftermarket are registered with an independent installation registration system which can be accessed by insurance companies. If seeking insurer recognition for the fitment of this product it is likely that the installation will have to be carried out by a Thatcham recognised installer.

A full list of Thatcham recognised installers is available at [www.thatcham.org/tri/home](http://www.thatcham.org/tri/home)

## 11. - DECLARATION OF CONFORMITY



Cobra Automotive Technologies  
CAT-VA

### Declaration of Conformity

The manufacturer hereby declares, at its sole responsibility, that the product:

Description: Wireless alarm system for automotive application  
Model: 4600  
Type: 4600 family with siren type 5365

is in conformity with the essential requirements of the R&TTE Directive 1999/5/EC.  
The product has been tested against the following standards and specifications:

EMC : ECER10  
Health and Safety: Relevant tests of ECER116 Regulation  
EN50371  
Radio Spectrum: EN 300 220-1  
EN 300 220-2

and declares that the:

**TRANSMITTERS** Models 8702, 8703, 8015 and 2771

conform to the essential requirements of the Radio and Telecommunication Terminal Equipment Directive 1999/5/EC in accordance to the following relevant standards and Directives:

Radio: EN 300 220-1/2  
EMC: EN 301 489-1/3  
Health & Safety: EN 60950  
EN 50371

The products are marked with the following CE marking and Notified Body number according to the Directive 1999/5/EC:

**CE 0678**

2011-10-14  
Dario Parisi  
Products Homologation Engineer  
Tel +39 0332 825111



The manufacturer shall not be liable for any faults or malfunctions in the anti-theft device and/or in the electrical system of the vehicle due to incorrect installation and/or to failure to comply with the indicated technical specifications. The system must only be considered as a deterrent against theft attempts.

**Cobra Automotive Technologies**  
via Astico 41 - 21100 VARESE - ITALY

[www.cobra-at.com](http://www.cobra-at.com)